

# BUTTERFLY VALVE VSL WITH LEVER

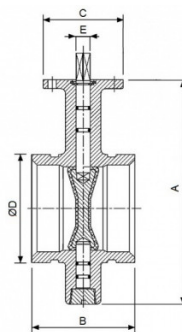

## APPLICATION

Full bore ball valve for water and fluids with connections for grooved pipe. Manual operation with lever. Ready to attack actuator ISO 5211 and DIN 3337.

## TECHNICAL DATA

Connection: grooved Operation: 90 ° rotation of the control member. Nominal pressure: PN 20. Working temperature: from - 20°C to + 160°C. Flow direction: in both directions. Pressure drop: see Kv in the table.

NB	Ø [inches]	A [mm]	B [mm]	ØC [mm]	ØD [mm]	ØE [mm]
50	2"	177	84	90	60,3	14
65	2" 1/2	197	97	90	76,1	14
80	3"	207	97	90	88,9	14
100	4"	255	116	90	114,3	18
125	5"	261	148	90	139,7	18
150	6"	328	148	90	168,3	21
200	8"	381	133	125	219,1	21

### PROSYSTEM ITALIA SRL

Via Friuli venezia Giulia, 15  
30030 Pianiga - Venezia - Italy  
T +39.041.510.1622  
F +39.041.5131351

P.IVA 03470750278  
Reg.Imp. Ve 03470750278  
Cap.soc. € 90.000,00  
REA Padova n° 311219

[info@prosystemitalia.com](mailto:info@prosystemitalia.com)  
[prosystemitalia.com](http://prosystemitalia.com)

Material:- Body: brass CW617N- Ball: brass CW614N- Handle: steel, PVC coated (black)- Seat ring, packing: P.T.F.E.- O-ring: NBR 70Sh.- Washer, ratchet, screw, reatainer, nut: steel.WarningsWe recommend the use of the valve in fully open or closed, not in mid. Operate at least twice a year.

## APPROVAL

EN 593.

Codice	Nome	Peso	Numero di pezzi
VSL-060	60,3 mm 2"	3	1
VSL-076	76,1 mm 2"½	3.5	1
VSL-060C		3	1
VSL-089	88,9 mm 3"	4	1
VSL-114	114,3 mm 4"	4.5	1
VSL-076C		3.5	-
VSL-139	139,7 mm 5"	6	1
VSL-076S	76,1 mm 2"½	3.5	1
VSL-168	168,3 mm 6"	7.5	1
VSL-219	219,1 mm 8"	12	1
VSL-089C		4	-
VSL-324	323,9 mm 12"	32	-
VSL-089S	88,9 mm 3"	4	1
VSL-114C		6.5	-
VSL-114S	114,3 mm 4"	4.5	1

### PROSYSTEM ITALIA SRL

Via Friuli venezia Giulia, 15  
30030 Pianiga - Venezia - Italy  
T +39.041.510.1622  
F +39.041.5131351

P.IVA 03470750278  
Reg.Imp. Ve 03470750278  
Cap.soc. € 90.000,00  
REA Padova n° 311219

[info@prosystemitalia.com](mailto:info@prosystemitalia.com)  
[prosystemitalia.com](http://prosystemitalia.com)